

Current Sensor CT58-S(T)

The CT58-S(T) adopts high-performance imported Hall elements and uses the magnetic compensation principle to achieve isolated measurement of DC, AC, or pulsed current. The output current is proportional to the measured current and offers excellent accuracy, linearity, and stability.

Parameters

Electrical Specifications

- Rated Measurement Current: 50Arms
- Overload Capacity: $\pm 70A$ 3min/h
- Turns Ratio: 1:1000
- Measurement Current: 50mA at 50A (rated)
70mA at 70A (maximum)
- Rated Output Current: 200mA
- Supply Voltage: $\pm 12 \sim \pm 15V$ ($\pm 10\%$)
- Current Consumption: 28mA (no-load) + output current
- Insulation Voltage: 6kVrms/50Hz/1min between primary and secondary circuits

Accuracy & Dynamic Performance

- Accuracy: $\pm 0.8\%$
- Non-Linearity: $\pm 0.1\%$
- Zero Offset: $\leq \pm 0.1mA$
- Response Time: $\leq 1\mu s$
- di/dt : $> 100A/1\mu s$

General Data

- Operating Temperature: $-40^{\circ}\text{C} \sim +85^{\circ}\text{C}$
- Storage Temperature: $-45^{\circ}\text{C} \sim +90^{\circ}\text{C}$
- Insulated, flame-retardant, self-extinguishing plastic housing
- Weight: $\leq 79\text{g}$

Outline & Interface

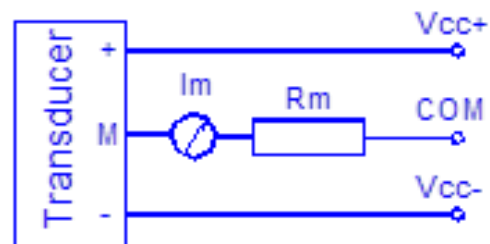
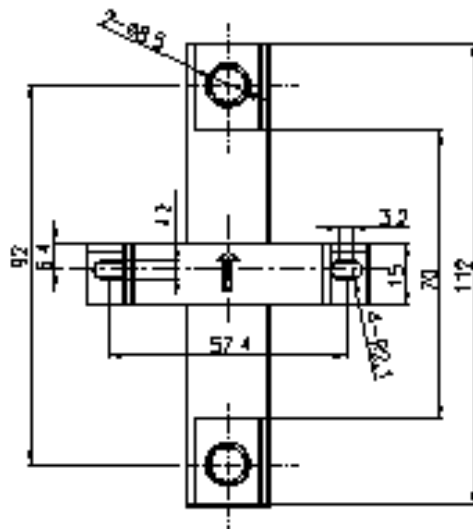
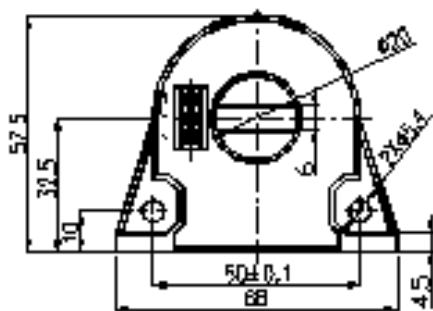

Notes

- The primary conductor should ideally fill the aperture to ensure measurement accuracy.
- The output current is positive when the direction of the measured current matches the arrow mark on the product housing; Otherwise, the output is negative.